

NNDC TPO (EDGEFIELD) 2023

No.23

LOCATION: Dam Hill, Holt Road,
Edgefield TPO/23/1036

PROPOSAL: Provisional woodland
TPO



NORTH
NORFOLK
DISTRICT
COUNCIL

north-norfolk.gov.uk

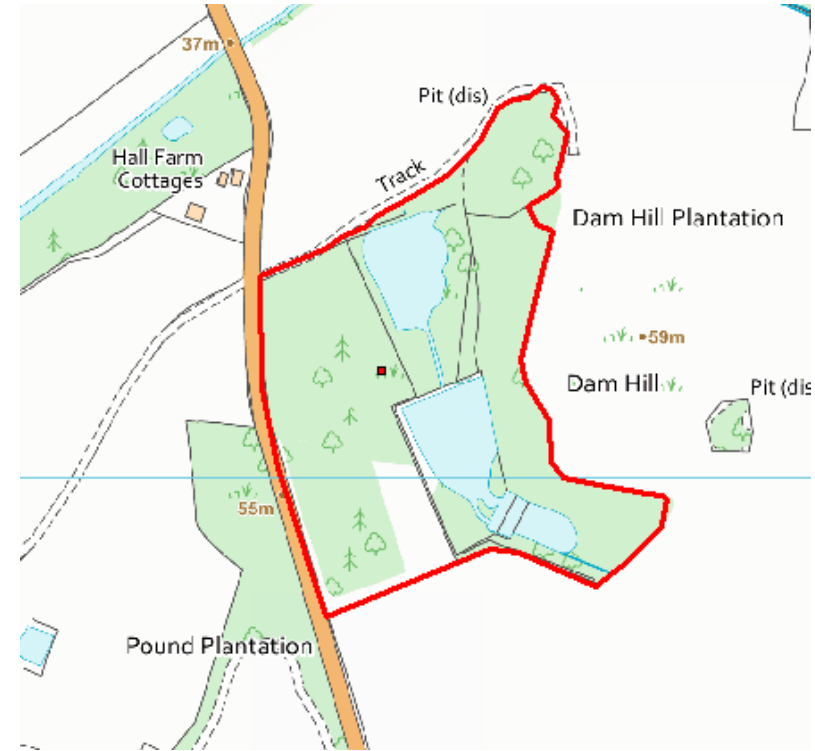

Dam Hill Site, TPO woodland area

Edgefield Hall

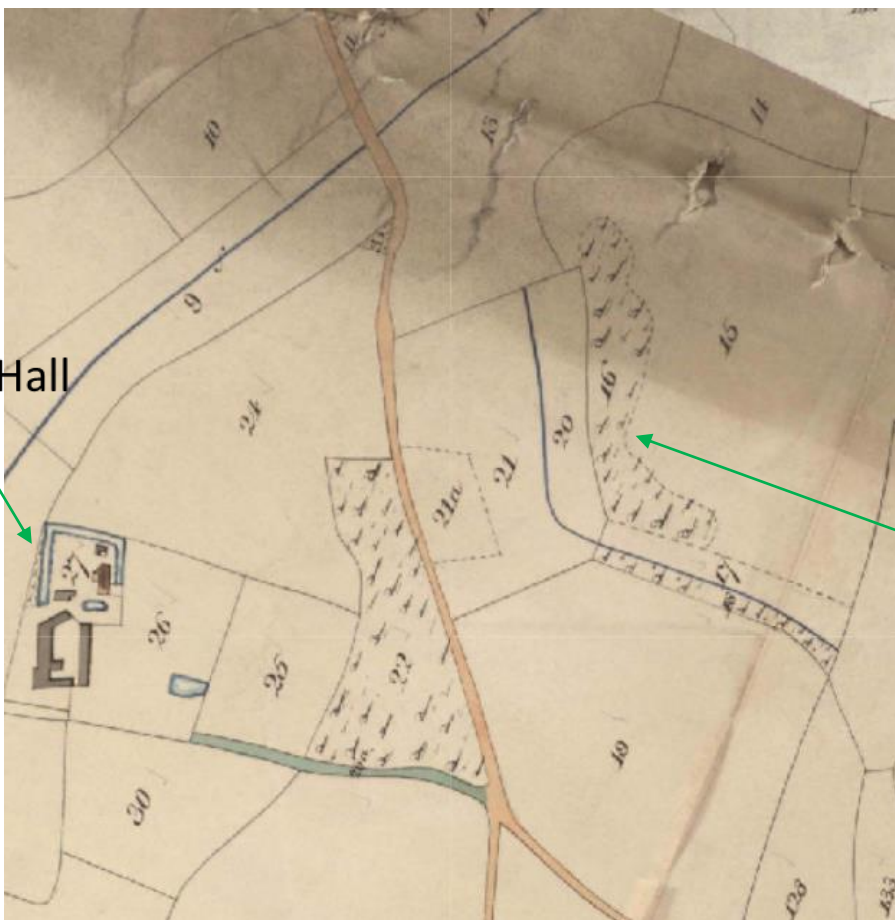

Edgefield Hall

Woodland with ancient features



RAF maps 1946-60

Tithe map 1836-50 (Norfolk County Historical map explorer)



Aerial map 2010

Norfolk County Historical map 1988

Protected sites and Statutory Designations

Holt Country Park, County Wildlife site

Holt Quarry,
Geodiversity site

Edgefield Heath
County Wildlife
site

Holt Lowes SSSI,
nationally
important
heathland and
wetland

Dam Hill site

Edgefield Heath Quarry, Geodiversity site

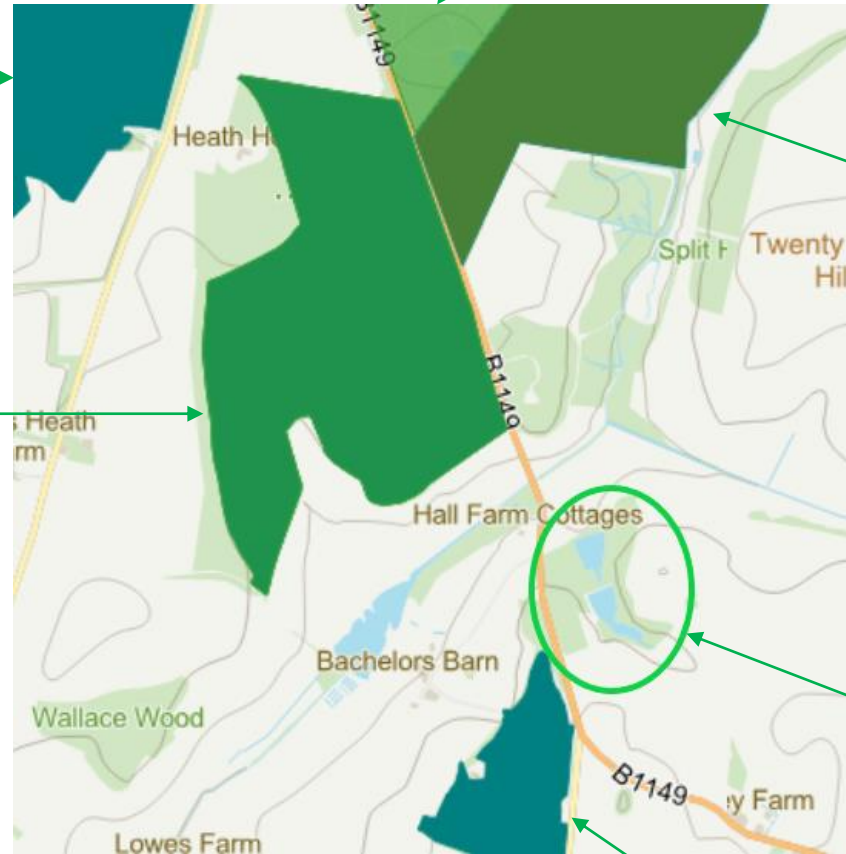

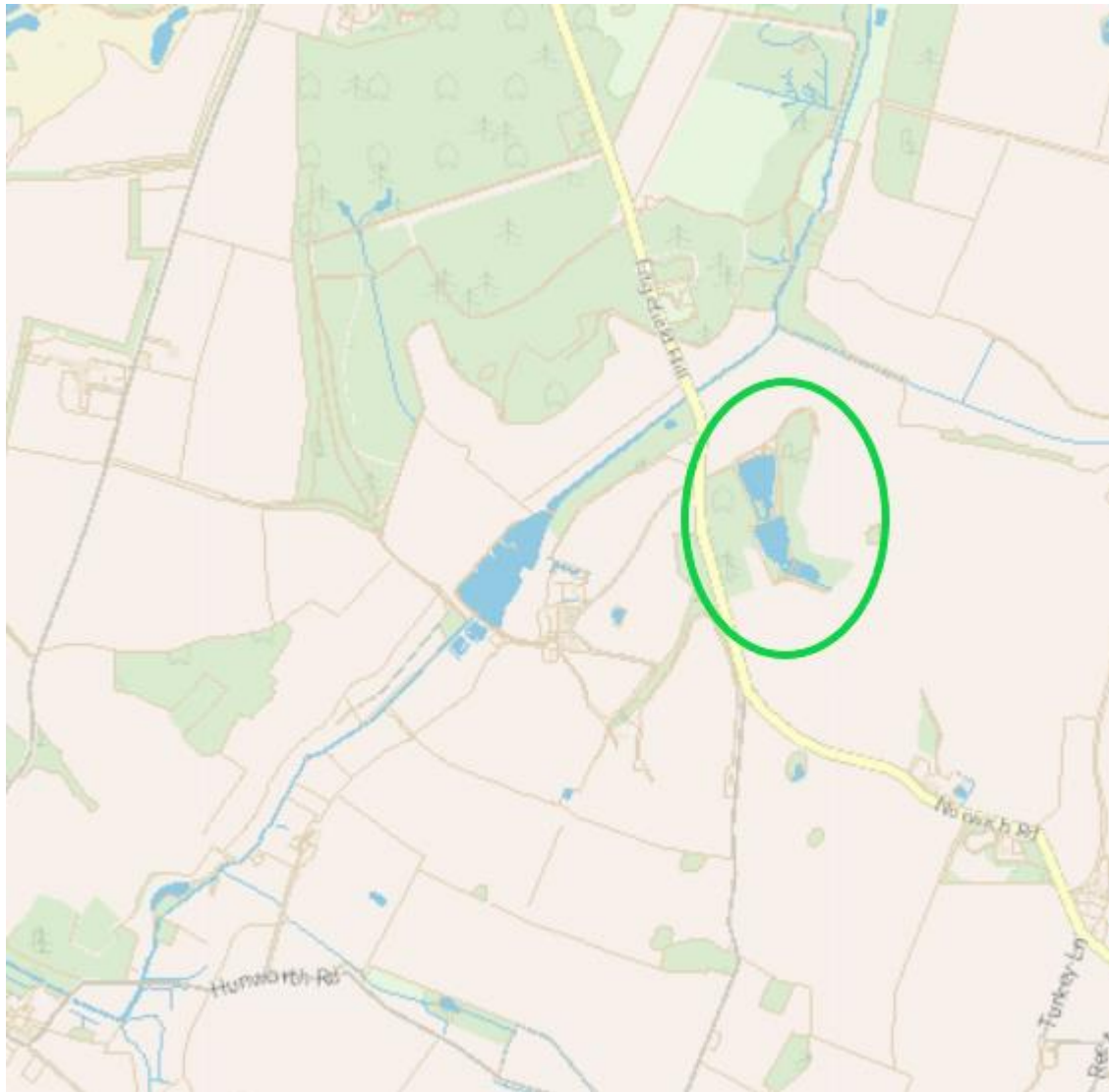

River Glaven

Situated diagonally across the landscape.

There is an outfall to the Glaven in the north of the Dam Hill site.



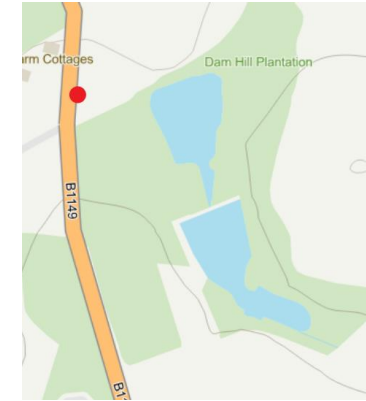

Streetview picture of the entrance to the site on left, heading south on the B1149

NP/23/1067 (May 23) Prior notification of proposed erection of building for agricultural or forestry use as a store, workspace and welfare room
Elevations and location plan



View of welfare unit siting looking south

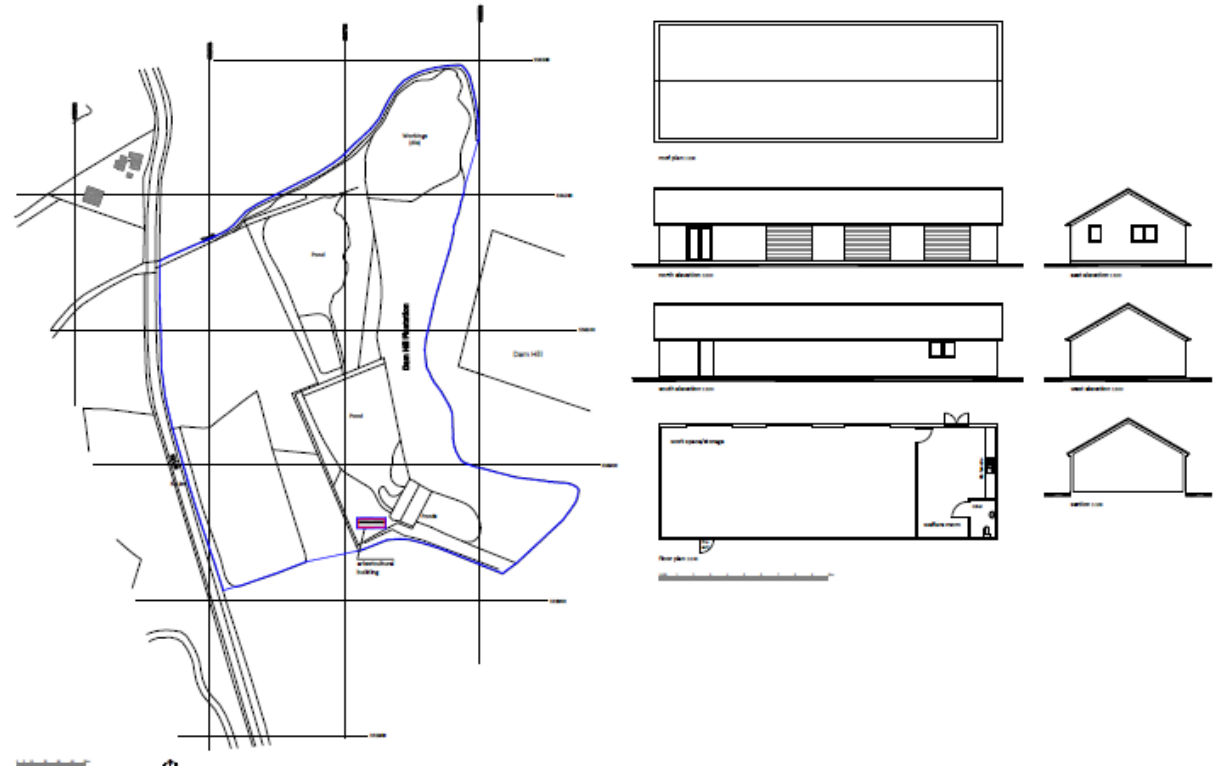

NP/23/2017 (Sep 23) Prior notification of proposed erection of building for agricultural or forestry use as a store, workspace and welfare room
Tree report submitted by Heritage Tree Specialist

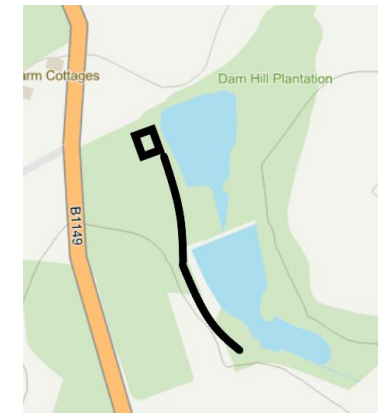
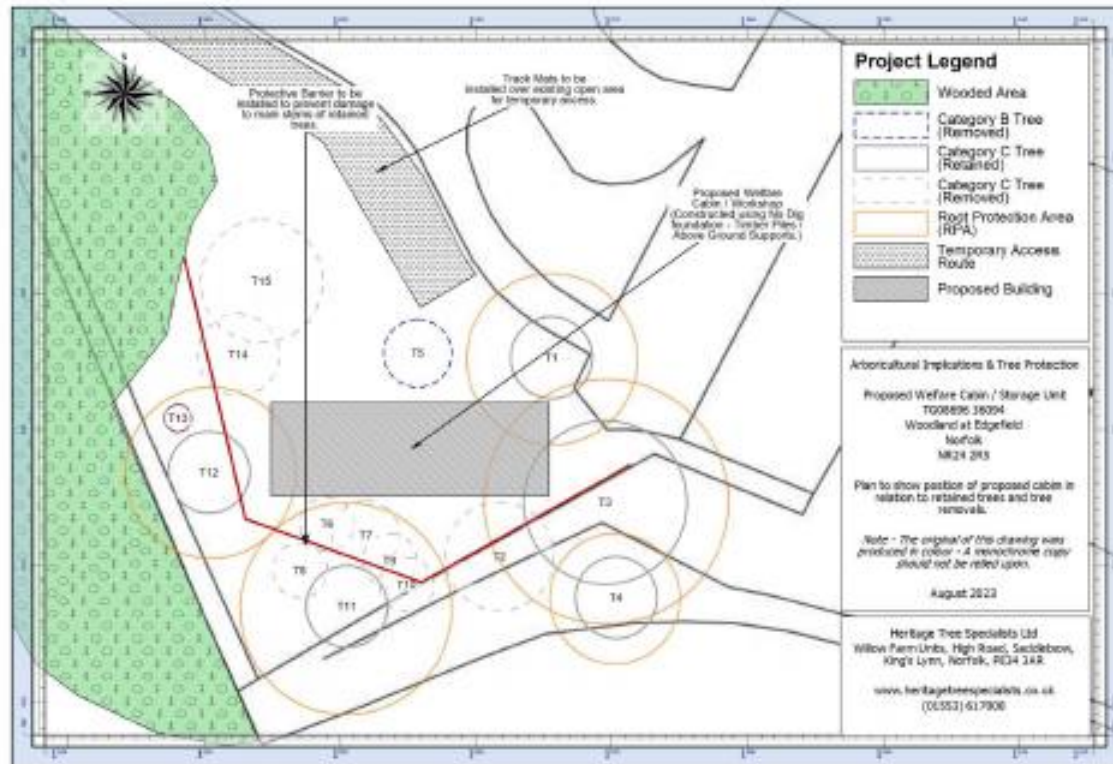

Car park
and
access
levelling
work

NP2/23/2374 (Oct 23) Submission of further details required in respect of prior notification of proposed erection of building for agricultural or forestry use as a store, workspace and welfare room (following decision for NP/23/2017)
Tree report submitted by Heritage Tree Specialist

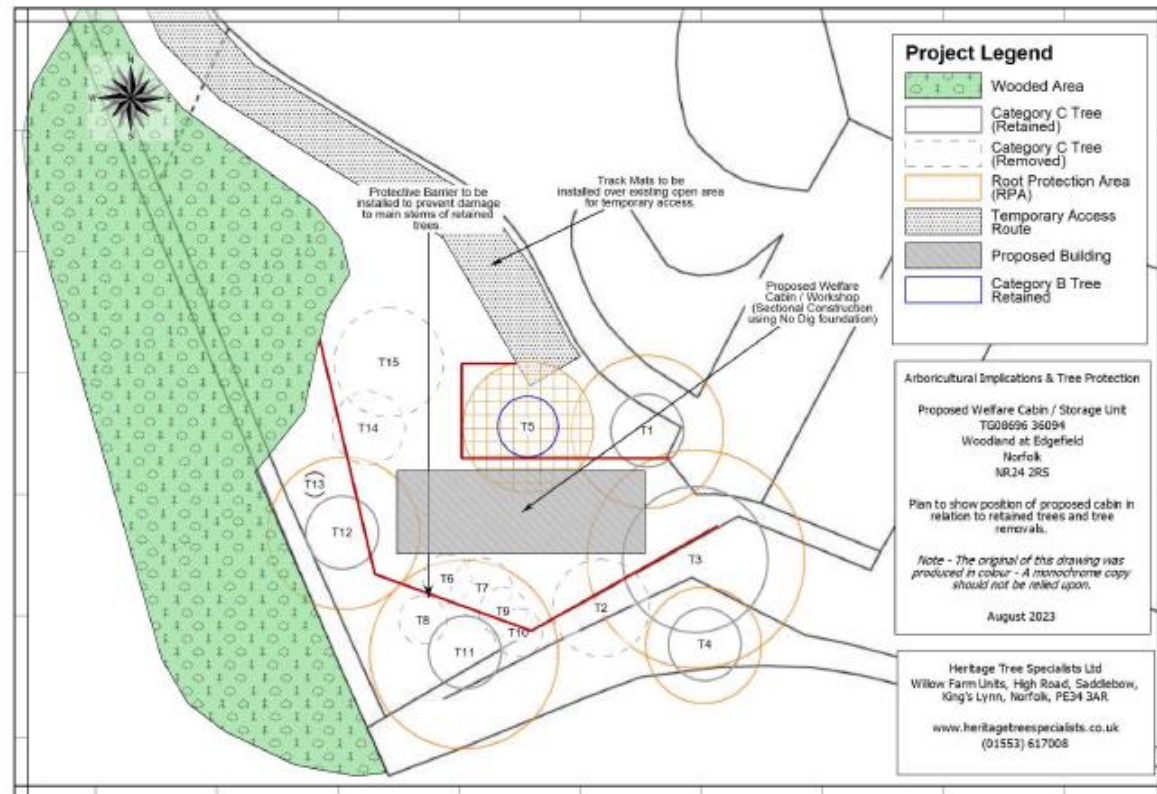

Trees along the bank of the pond

Operations Map

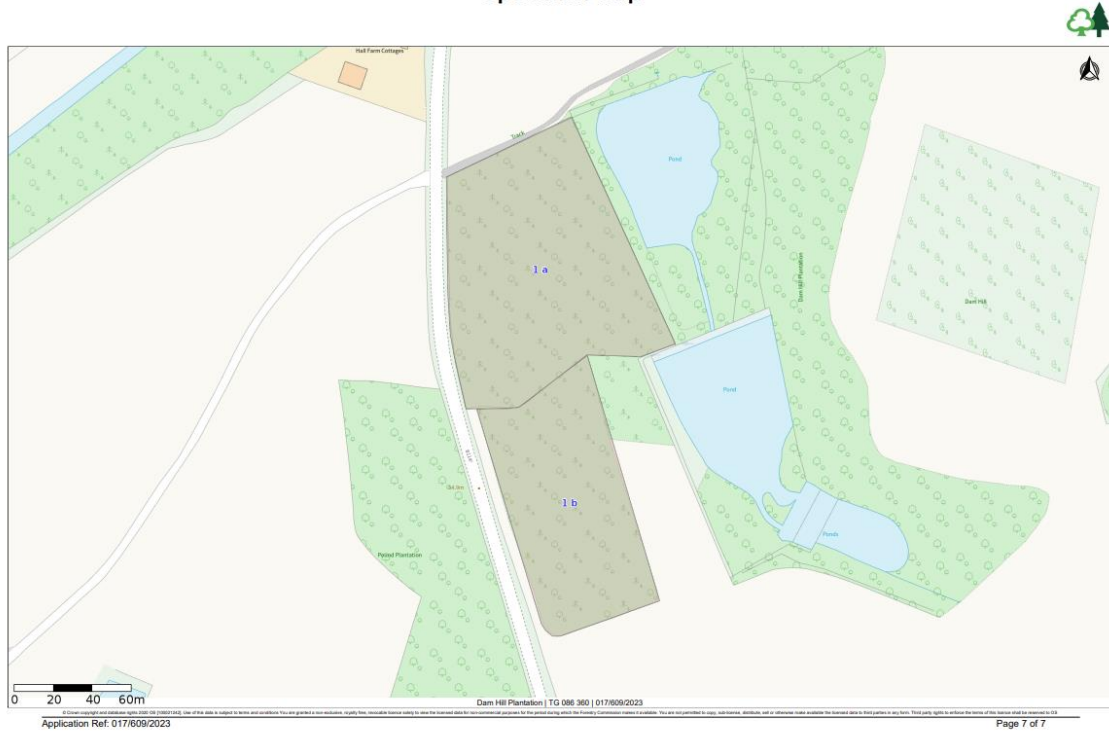

Licensed work, 017/609/2023 operations map compartments to east

Forestry Commission Licence maps

Operations Map



Licensed work, 017/128/2024 operations map compartment to west



Camping & caravanning areas in red outline

Location of Forestry welfare room

Exemption certificate submitted Aug 23 for camping and caravan site illustrating proposed site usage areas





New shepherd huts Dec 23



Roadway levelling work to access the dam





Ancient pollard oak, root damage through levelling work



Water connection infrastructure

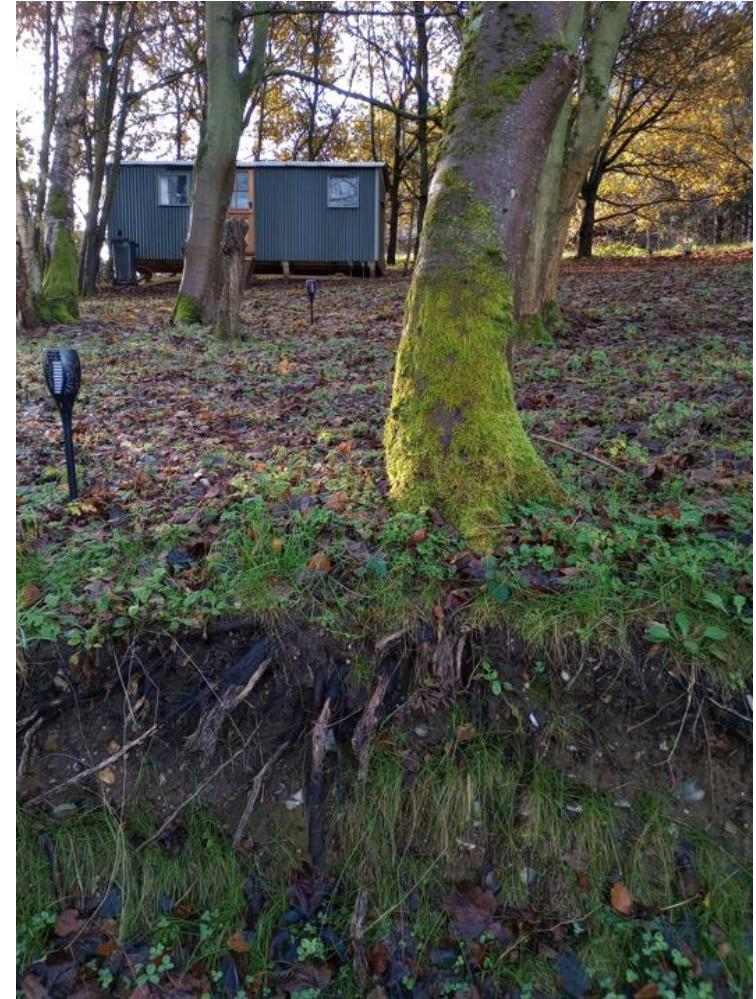
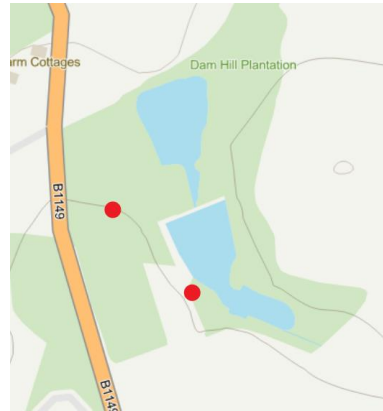

Root damage to sycamore tree

Recommendation – confirm Order NNDC TPO (EDGEFIELD) 2023 No.23

